

FRONT SHELL

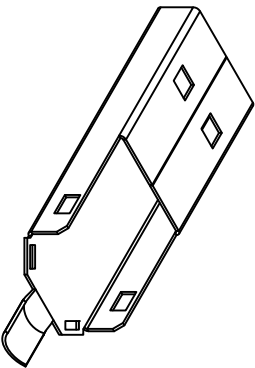

INSERTED BODY

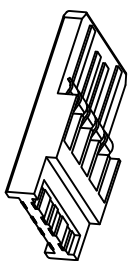

REAR SHELL

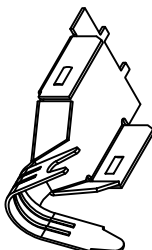

ASSEMBLED PLUG

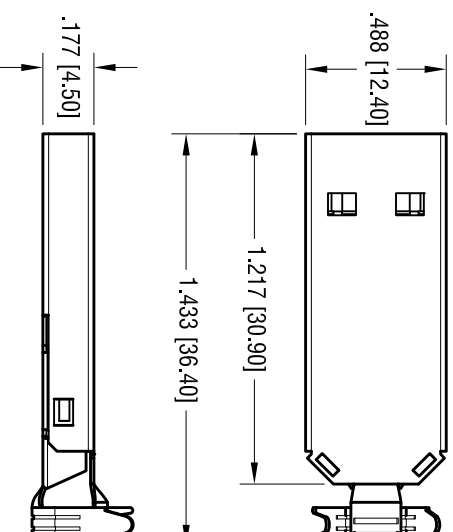
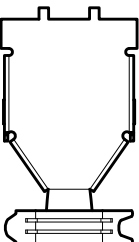
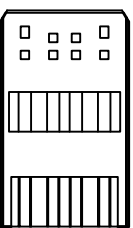
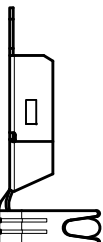
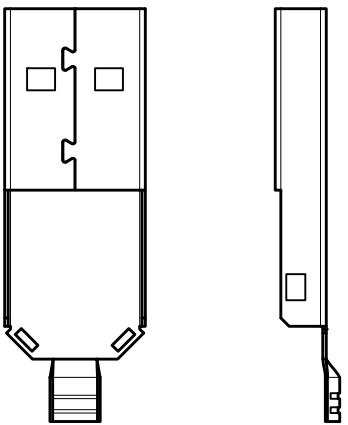
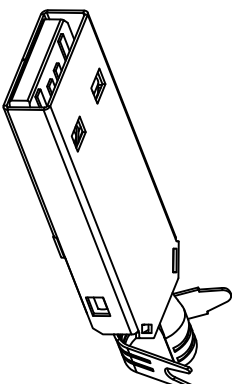

PLUG SPECIFICATIONS:

SHELL: MAT'L- STEEL
 FINISH- NICKEL PLATE
 INSULATION: MAT'L- THERMOPLASTIC, UL 94V-0
 CONTACT: MAT'L- PHOSPHOR BRONZE
 FINISH- GOLD FLASH OVER NICKEL

ELECTRICAL CHARACTERISTICS:

RATED VOLTAGE: 30V (RMS)
 CONTACT CURRENT RATING: 1 Amp DC MAX.
 CONTACT RESISTANCE: 15m Ω min.
 DIELECTRIC WITHSTANDING VOLTAGE: 750V AC FOR 1 MINUTE
 MECHANICAL CHARACTERISTICS:
 OPERATING TEMPERATURE: -13°F (-25°C) TO 176°F (+80°C)
 DURABILITY: 1500 CYCLES MIN.

KEYSTONE ELECTRONICS CORP.			
www.keystone.com • ASTORIA, N.Y. 11105-2017 • Tel (718) 956-8900			
PART NAME		USB 3.0 TYPE A PLUG KIT	
MATERIAL		AS NOTED	
FINISH	AS NOTED		
TOLERANCES	INCH	[MM]	CODE
DECIMAL	± .010	[± 0.25]	C
ANGULAR	± 1°		
UNLESS OTHERWISE SPECIFIED		DRN BY	DATE
		NT	4.07.10
		App'D	SCALE
		LN	1.5X
		DWG NO.	947

THIS DOCUMENT IS THE PROPERTY OF KEYSTONE ELECTRONICS CORP. AND SHALL NOT BE REPRODUCED, DISTRIBUTED OR USED AS A BASIS FOR MANUFACTURE WITHOUT PRIOR WRITTEN PERMISSION FROM KEYSTONE ELECTRONICS CORP.

DATE	DESCRIPTION	REV.
7.16.14	CHANGE AS PER ECN 14-066 SPLIT C/M DRAWING TO 'C' & 'M'	A